

KEY CONTROL ROUND DEADBOLT - GCD9571

Box Pack Specifications



SATIN NICKEL



SATIN CHROME



POLISHED CHROME





MATTE BLACK



These finishes are available with Microban anti-microbial coating: 15 and 514



GD9571		 20 min.	 3 Hour	Satin Nickel	Polished Chrome	Satin Chrome	Matte Black
Single Cylinder	GCD9571 RDT	<input type="checkbox"/>	<input type="checkbox"/>	<input type="checkbox"/>	<input type="checkbox"/>	<input type="checkbox"/>	<input type="checkbox"/>
Double Cylinder	GCD9571 RDT	<input type="checkbox"/>	<input type="checkbox"/>	<input type="checkbox"/>	<input type="checkbox"/>	<input type="checkbox"/>	<input type="checkbox"/>

SPECIFICATIONS

Door Prep	Cross Bore 2-1/8" Edge Bore 1" Latch Face 1" x 2-1/4"
Backset	Adjustable to 2-3/8" or 2-3/4"
Door Thickness	1-3/8" - 1-3/4" doors standard. 2-1/4" doors optional
Cylinder	SmartKey or KW 5-pin or WS 5-pin
Faceplates	1" x 2 1/4" Specify round corner or square corner or drive-in
Strikes	1-1/8" x 2-3/4" Specify round corner or square corner
Bolt	1" throw. Steel.
Door Handing	Reversible for right or left-handed doors
ANSI/BHMA	A156.5 Grade 2
ADA	Interior turn piece meets 4.13.9 ADA requirements
UL	*Meets 3 hour fire rating for all UL functions when fronted latches used
ASTM	All Weiser product meets ASTM E 331 water penetration testing



20 min.



3 Hour

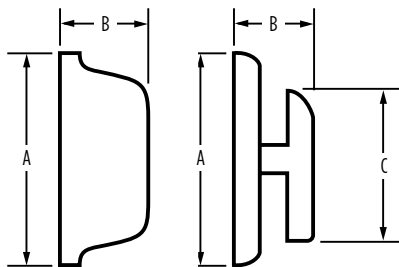

Dimensions	A	B	C
GCD9571 RDT Interior	2 9/16"	1 5/8"	1 13/16"
GCD9571 RDT Exterior	2"	1 5/8"	

WARRANTY:

Weiser™ products provide a "Lifetime Mechanical Warranty" that covers all defects in material and workmanship. For more information, please visit ca.weiserlock.com/en/warranty/.